

2010 FORD MUSTANG - V6 4.0L, SINGLE EXIT

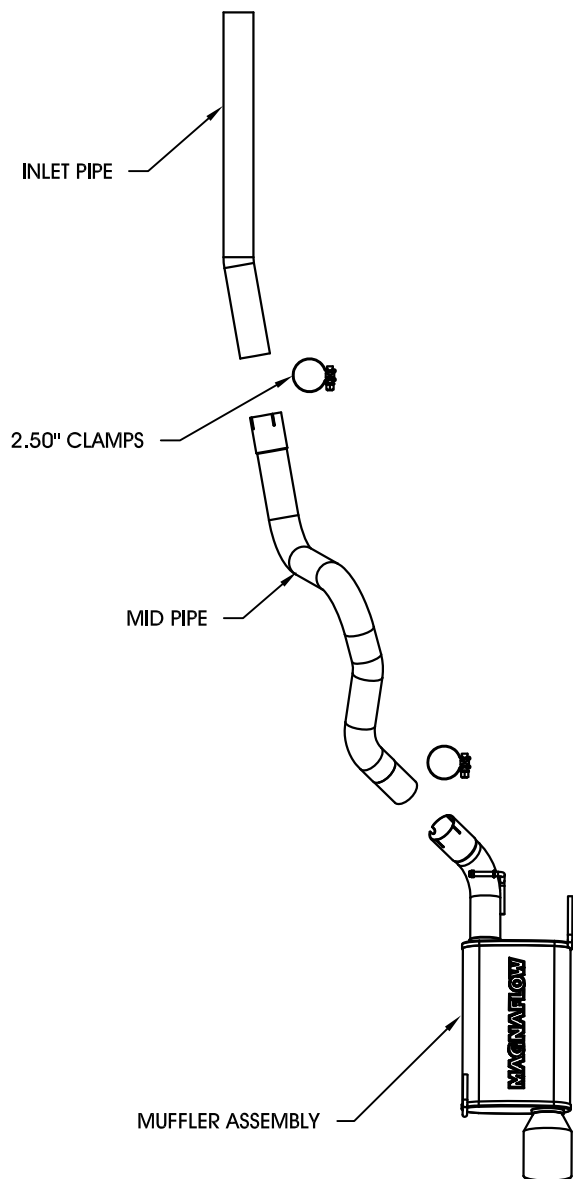

Warning: When working on, under, or around any vehicle exercise caution. Please allow the vehicle's exhaust system to cool before removal, as exhaust system temperatures may cause severe burns. If working without a lift, always consult vehicle manual for correct lifting specifications. Always wear safety glasses and ensure a safe work area. Serious injury or death could occur if safety measures are not followed.

Step 1: (Carefully read all instructions before installation) Disconnect the vehicle's battery before removal of the OEM exhaust, this will allow the computer to reset itself with the new system and prevent electrical accidents. Begin removal of the OEM system by loosening the band clamps that fasten the muffler and over-axle pipe to the catalytic converter. Unbolt the mounting brackets that mount the muffler to the frame, and remove the muffler assembly. Do not discard the OEM mounting brackets or fasteners as they will be reused to mount the new mufflers. You can now remove the over-axle pipe as well.

Step 2: Mount the OEM muffler bracket to the hanger of the new Muffler Assembly, and install the Muffler Assembly by bolting the mounting bracket to the frame using the OEM fasteners. Install the new Inlet/Mid Pipes using the supplied 2.50" clamps and OEM front clamp, attaching them to the Muffler Assembly and the exhaust Y-pipe outlet .

Step 3: With all components mounted loosely, adjust the system for overall aesthetics and clearance of frame & bodywork. (MAGNAFLOW recommends at least 1/2" of clearance between the exhaust system and any body panels to prevent heat-related body damage or fire.)

Step 4: Once a final position has been chosen for the new system, evenly tighten all fasteners from front to rear. The supplied band clamps must be VERY tight to properly align the pipes and prevent leaks (Approximately 40 ft-lbs). Inspect all fasteners after 25-50 miles of operation and retighten if necessary.

*MAGNAFLOW Performance Exhaust recommends professional installation on all their products

Technical support: 1-800-959-9226 ext. 4500